

INSTALLATION GUIDE

Lead screen fitting instructions.

Before you start.

Therm-A- Glaze intumescent strip is applied to the screen side of the lead tongue as well as the hardwood beading on the opposing side of the lead glass, as indicated below. Ensure no fixings come into contact with the glazing. It is important that all fixings are within the permitted distances as shown below. Handle lead glass with care as it is very brittle and can be marked or scratched easily. Straighten out the lead tongue if it has been distorted in transport or handling.

Fixing the sidelight frame.

- First, it is important to assess which side of the screen you wish to install the lead glass from. This will determine which orientation to install the screen frame as indicated opposite.
- Note: the lead tongue will be off-centered. This side should be on the opposite side to that of which the lead glass will be installed.

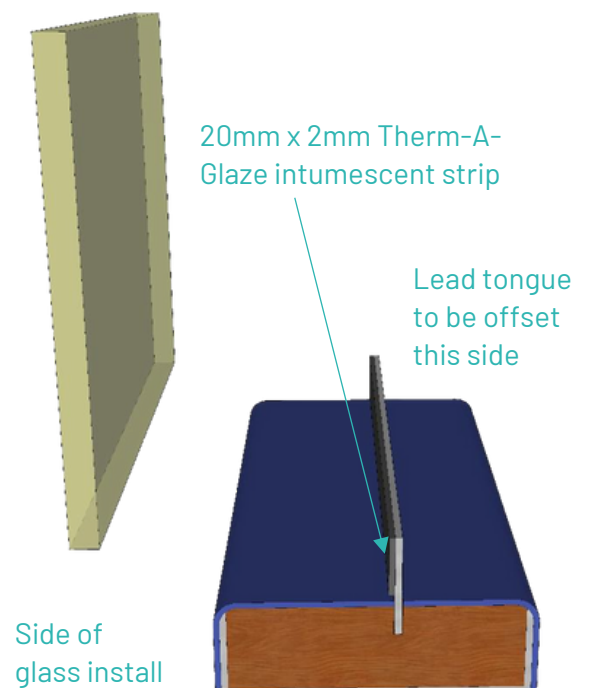

- Offer the frame into the structural opening. Taking care not to damage the lead shielding.
- Once the screen is in place it can now be fixed into place.

- Fixings are to be a maximum of 100mm from the edge the frame and 500mm centers as shown below.

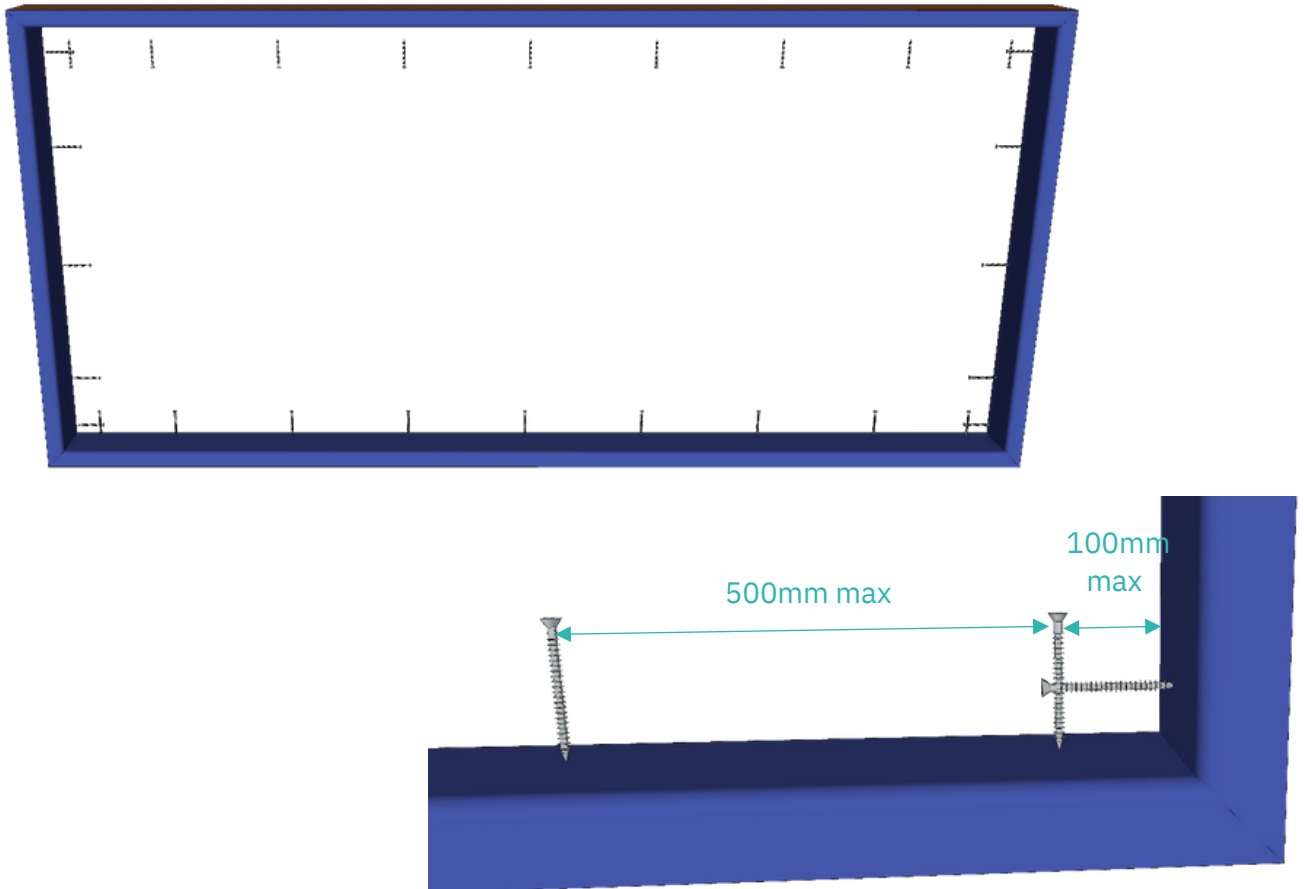

- Fixings should penetrate a minimum of 40mm into the substrate.
- These fixings should be concealed behind the beading.
- Adding a second row of fixings is good practice due to the nature and weight of a lead frame. This second row of fixings should be staggered from the initial row of fixings.
- Packers should be used where required to space and stabilize the frame within the structural opening.

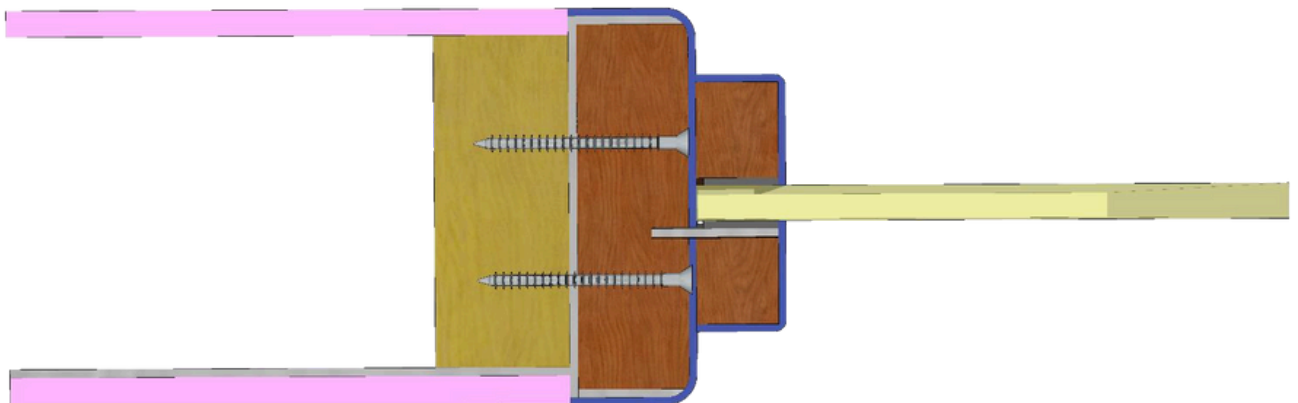

Fitting the first set of glazing beads.

- Butt the mdf beading up to the back of the lead tongue as indicated below. Start with both the head and the sill. These should run the full internal width of the frame.
- After which install both vertical beads.
- Pre-drill and countersink the beading, 50mm from the edge of the beading and 250mm maximum centers.
- Fix the head and the sill beading first.
- Aim for a 20° angle inwards towards the glazing.
DO NOT allow the fixings to come into contact with any glazing.

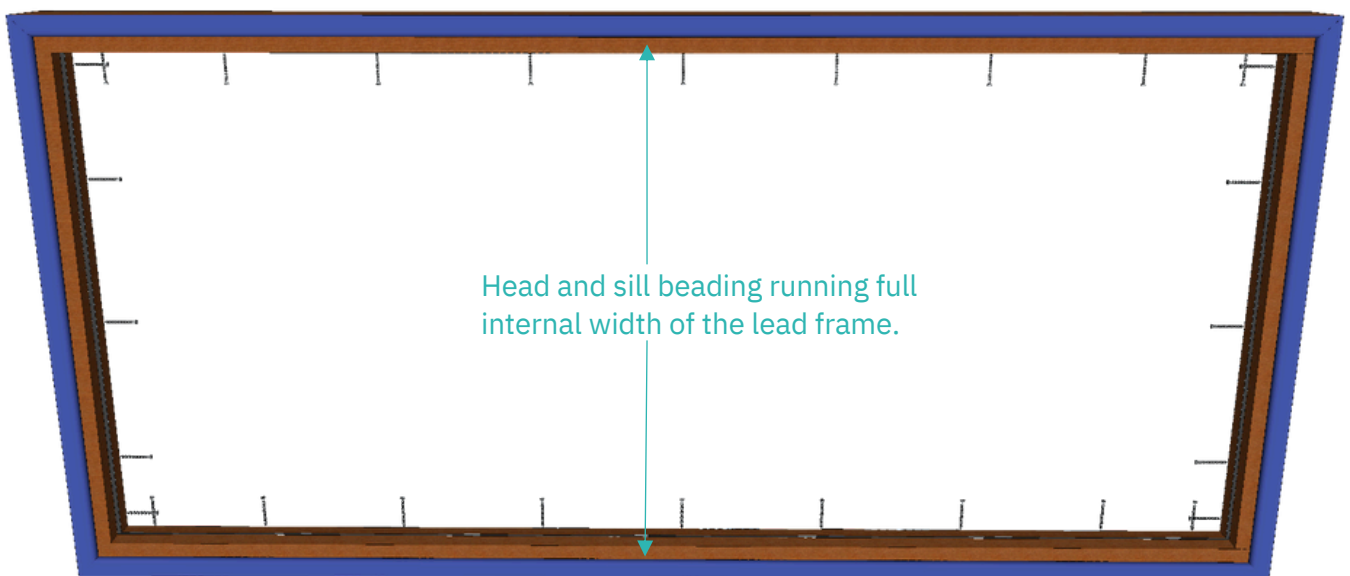
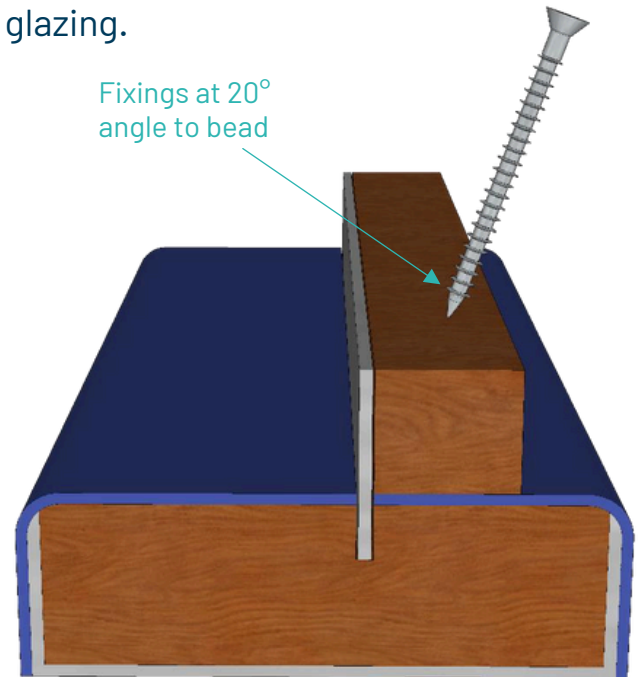

Fitting the PVC cover to the first half of glazing beads.

- Covers are to be mitred.
- Apply foam tape to the center of one side of the beading.
- Apply a bead of PinkGrip to the internal corner of the PVC cover.

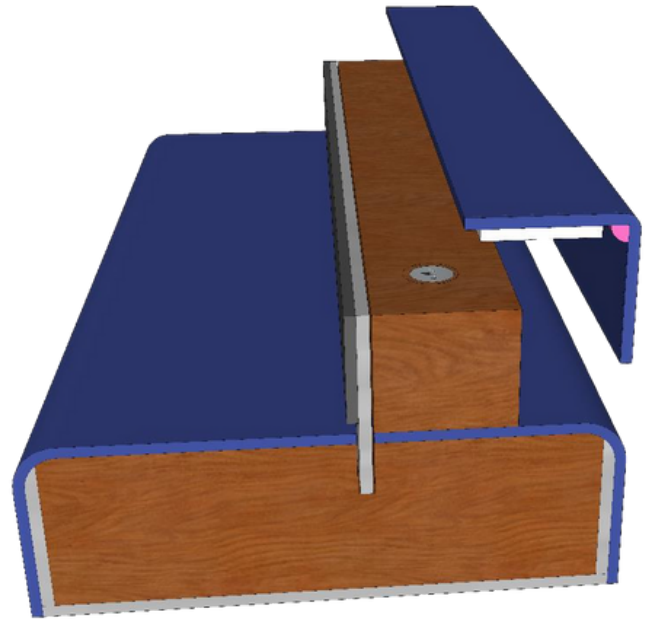

- Fix into place, ensuring no gaps in the covers.

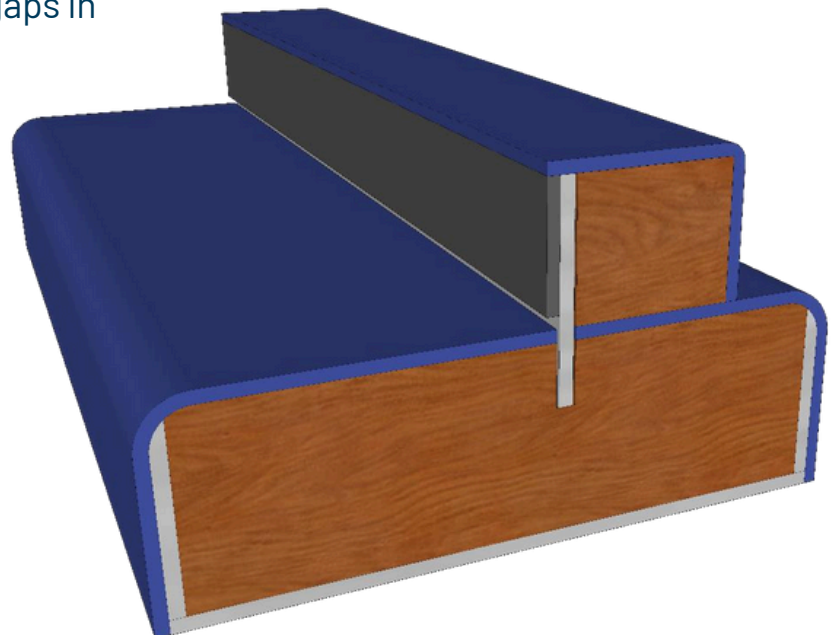

Fitting the glazing.

- Apply a generous bead of intumescent mastic to the internal corner of the beading as shown in the image opposite.



- Position the glazing into place. It can help to angle the base of the glazing into position first.
- It may be of benefit to have your secondary beading pre-cut, pre-drilled and counter-sunk to aid with ease of installing the glazing.
- Apply the 20mm x 2mm Therm-A- Glaze intumescent to one side of the beading all around the frame.

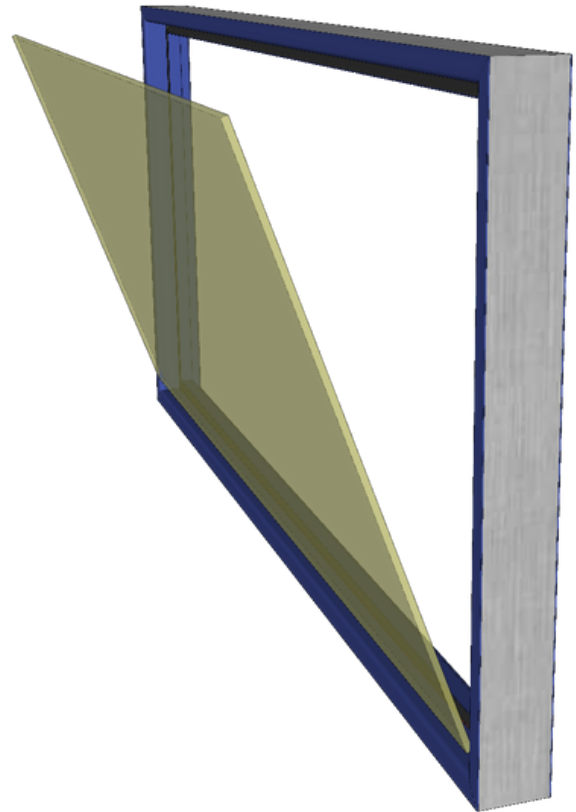

- Align the head and sill of the secondary beading and before fixing, ensure the beading is fully butted up to the face of the glazing, with the intumescent strip in contact with the glazing as shown in the image opposite.
- Secure in place as before with the same 50mm and 250mm between hole centers as before.
- Run a bead of intumescent mastic along the edge of the glass, which the secondary beading will compress against.
- Apply PVC Cover to secondary beading as before.

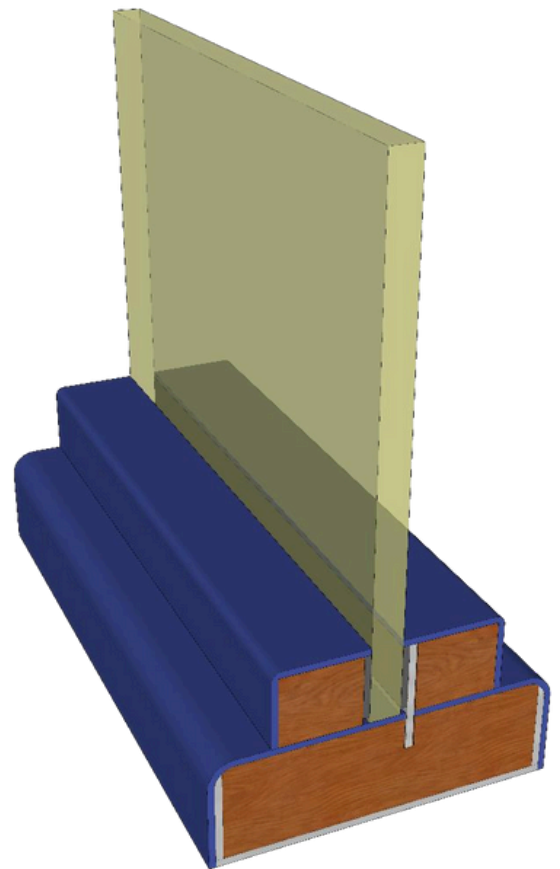
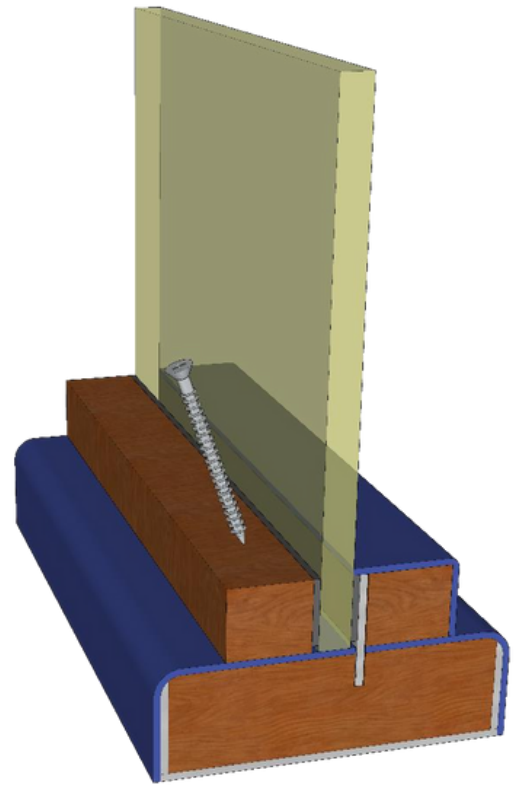

Architraves.

- The Architrave cores are lead lined to ensure the lead shielding is impenetrable on either side of the frame. These overlap the lead lined wall construction.

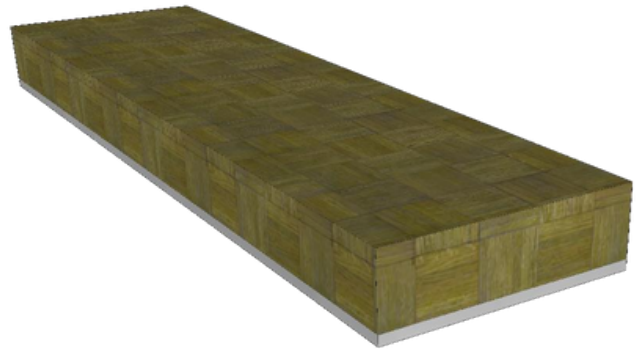

- The lead lined architrave cores are to be butt jointed as shown in the image below. Ensure the lead face is butted against the frame.

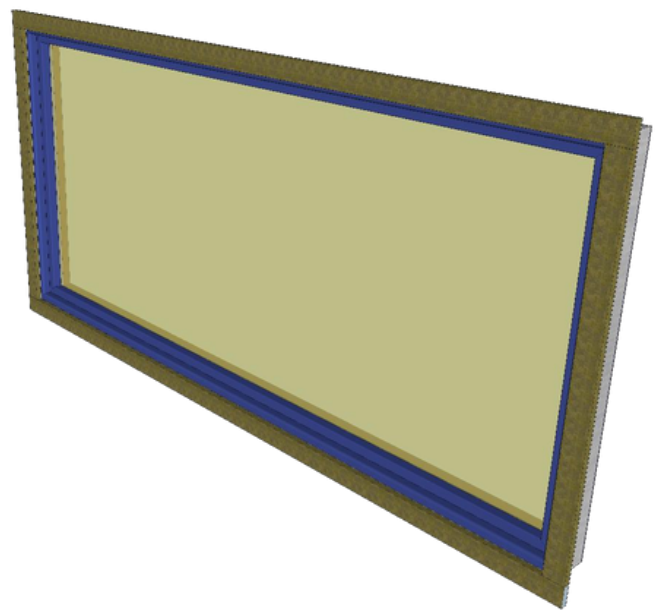

- The mdf cores should be offset 14mm from the inside of the frame. As shown in the above image.

- There should be a minimum of 15mm overlap onto both the frame and the structural opening.

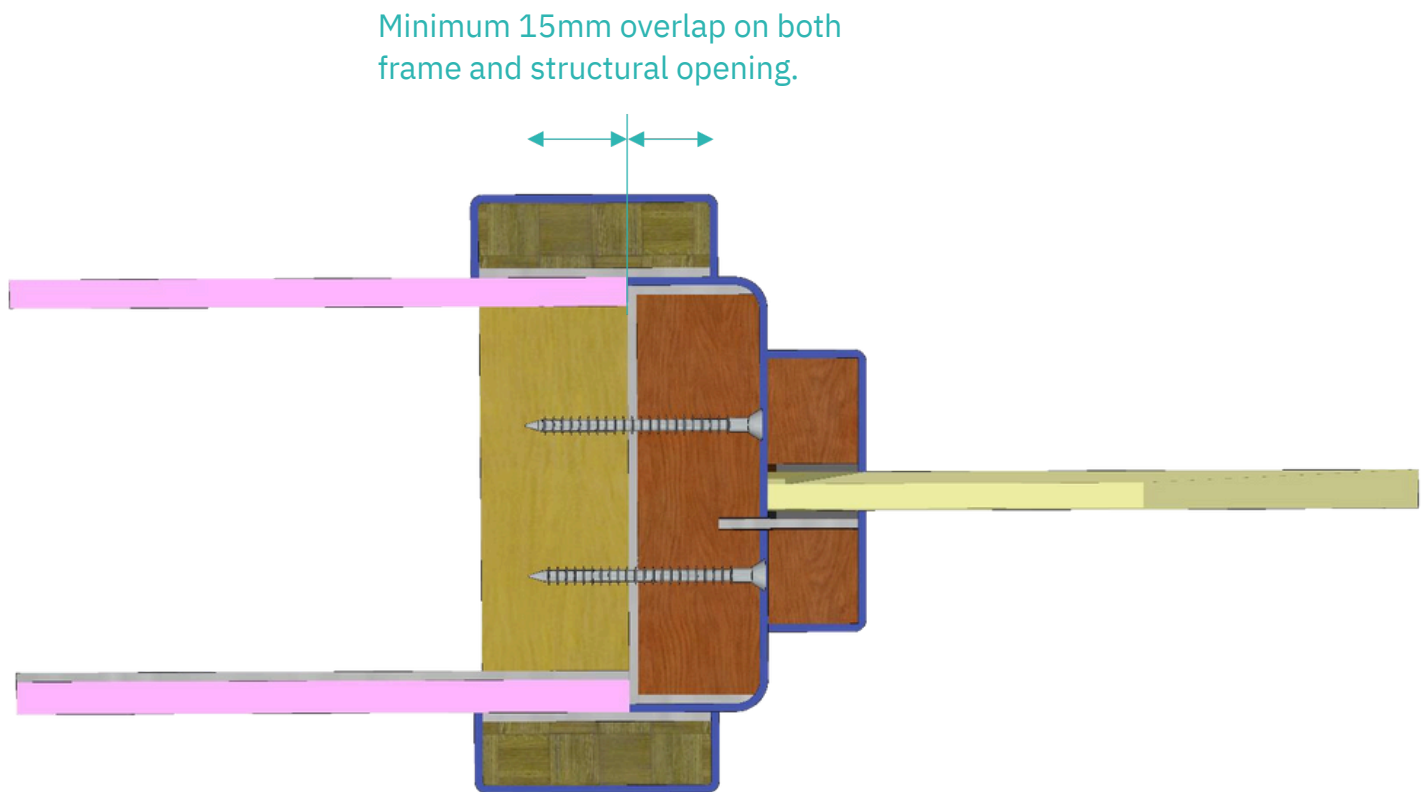

- Repeat on both sides of the frame.

PVC covers.

- Mitre PVC covers to correct sizing.
- Once mitred, ensure PVC covers are clean and free of dust.
- Apply a strip of the supplied double-sided foam tape to the centre of the PVC cover. (Two strips of tape can be used for wider doorstops).

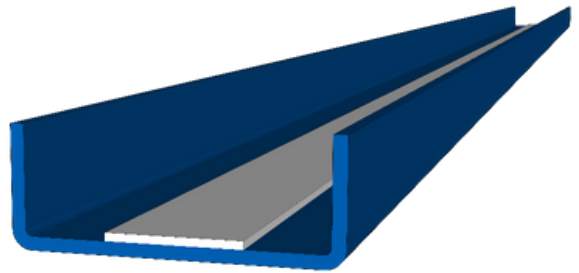

- Apply a bead of PinkGrip adhesive to both internal corners of the PVC cover.

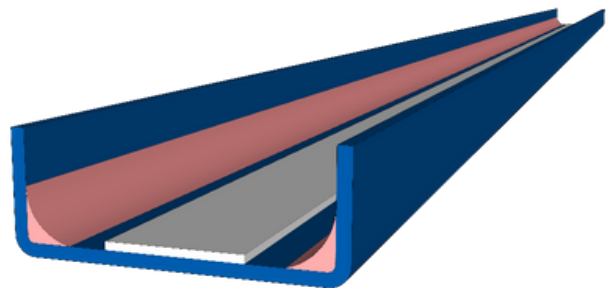

- Push the PVC covers onto the MDF core, ensuring that the double-sided tape makes contact with the MDF core. The double-sided tape will provide an instant but temporary hold, whilst the PinkGrip adhesive cures. Fit one jamb, working your way around the frame often referred to as "chasing the mitre".
- Repeat on other side of the frame.

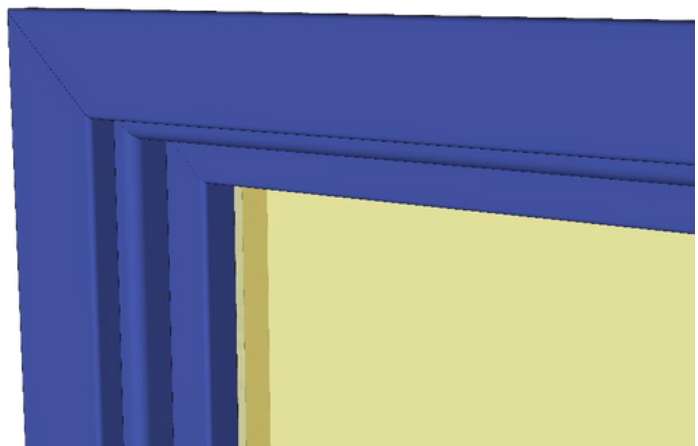
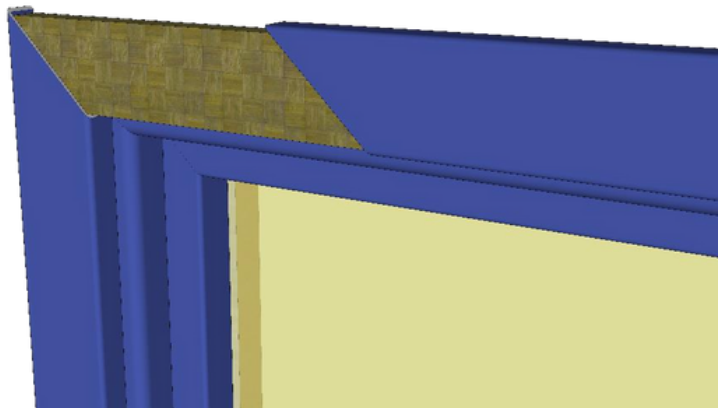

Final checks.

- Ensure all PVC mitres join up and there are no gaps in the PVC.
- Check that the glazing is fully secured within the beading and frame. There should not be any movement.
- Make sure that throughout the installation the lead shielding incurred no damage. Any damage must be reported for repair.

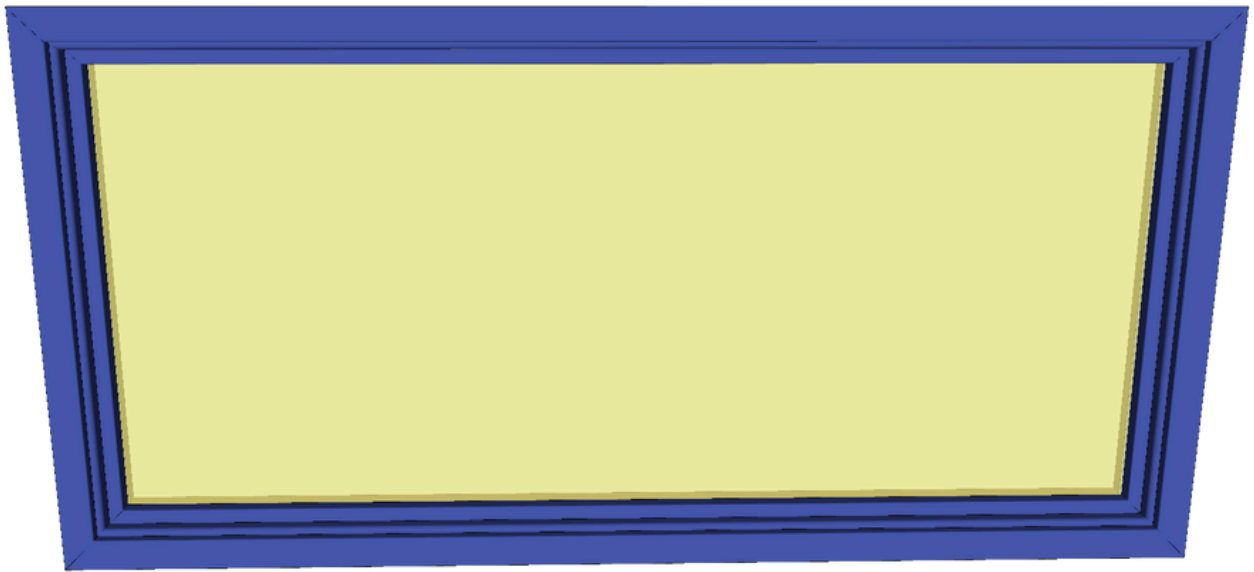



For further information, contact us:

T 01420 543222

E sales@specialistdoorsolutions.com

Unit 1 Bordon Trading Estate, Old Station Way, Bordon, Hampshire GU35 9HH

specialistdoorsolutions.com