

INSTALLATION GUIDE

Overhead panel fitting instructions.

Before you start.

- For firerated doorsets, ensure all intumescent products are in place.
- The structural opening measurements coincide with the measurements of the door frame, with room for fire stopping.
- When joining the overhead panel frame back-to-back with the door frame. You must ensure there are no gaps between the frame constructions.

In most cases the overhead panel should be fixed to the head of the door frame prior to the door frame installation.

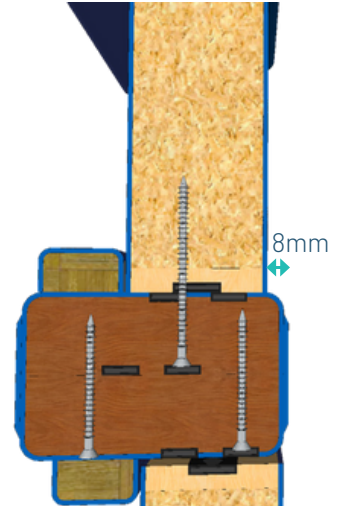

Fixing the overhead panel into the overhead panel frame.

- The overhead panel must be offset 8mm from the extent of the overhead panel frame. This ensures no exposed lipping is visible.
- When fixing the overhead panel to its frame, fixings must be a maximum of 100mm from each corner and a maximum of 250mm centers.

Fixing the overhead panel and frame to the door frame.

- Ensure there are no gaps between the two frames. One fixing is to be concealed behind the outer intumescent of the door frame.
- The other is to be concealed behind the doorstop yet to be fixed into place.

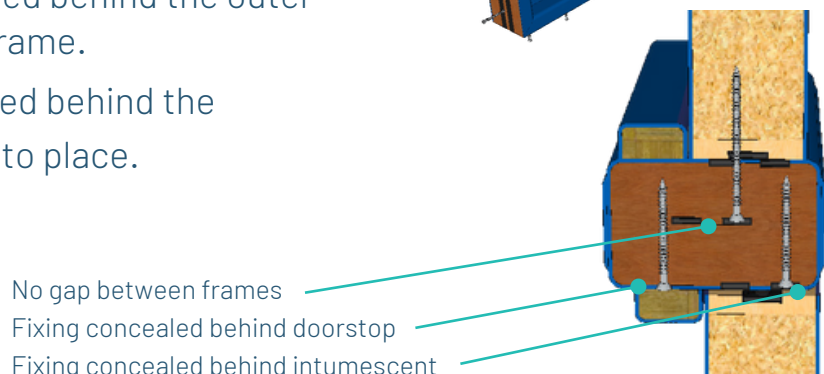
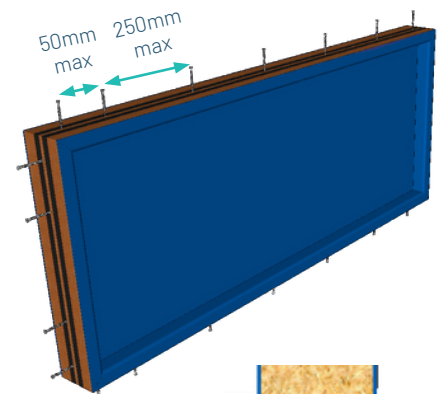

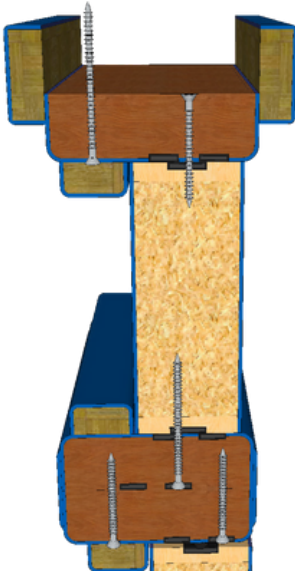

Fixing overhead panel frame to structural opening.

- Fixings are to be a minimum of 40mm into the structural opening.
- Fixings are to be concealed behind the doorstop.

Architraves/beveled strip.

- The Architraves run the full height of both the door frame and overhead frame.

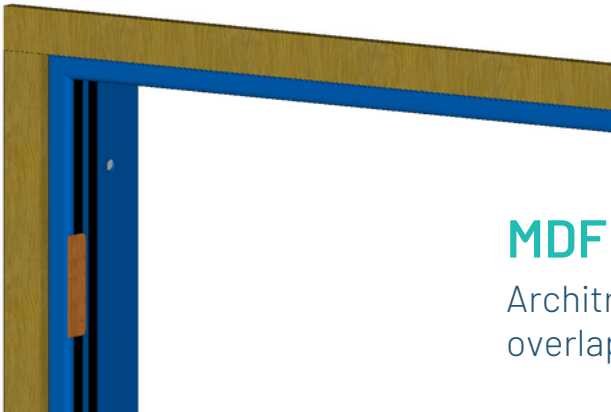

MDF core.

Architraves (including the PVC covers) must overlap the wall by a minimum of 15mm.

- Cut the MDF architrave to suit the size of the door frame. Architrave MDF to be butt jointed as illustrated.
- Fix the vertical and horizontal MDF sections to the frame using pins/screws.
- Repeat on other side of the frame.
- Ensure MDF cores are left dust-free ready for the PVC covers.

PVC covers.

- Mitre PVC covers to correct sizing.
- Once mitred, ensure the PVC covers are clean and free of dust.
- Apply a strip of the supplied double-sided foam tape to the centre of the PVC cover.

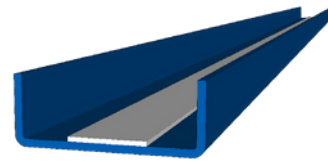

- Apply a bead of 'PinkGrip' adhesive to both internal corners of the PVC cover.

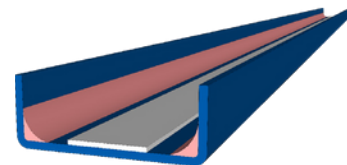

- Push the PVC covers onto the MDF core, ensuring that the double-sided tape makes contact with the MDF core. The double-sided tape will provide an instant but temporary hold, whilst the 'PinkGrip' adhesive cures. Fit one jamb, followed by the head and then the remaining jamb.
Ensure there are no gaps in the PVC covers.

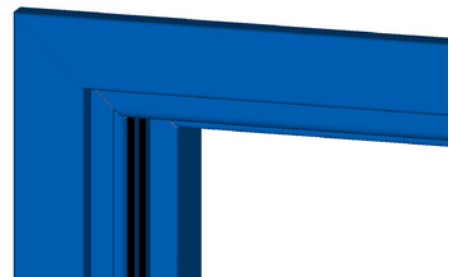

Beveled strip.

- The beveled strip covers the reveal between the two frame sections. Running the internal width of the frame. Fix using the supplied double-sided tape. Butted up to the internal width of the architrave.



For further information, contact us:

T 01420 543222

E sales@specialistdoorsolutions.com

Unit 1 Bordon Trading Estate, Old Station Way, Bordon, Hampshire GU35 9HH

specialistdoorsolutions.com