



INSTALLATION GUIDE

# Sidelight fitting instructions.

## Before you start.

- If fire rated, ensure Therm-A-Glaze intumescent strip is on the back of the hardwood beading.
- Ensure no fixings come into contact with the glazing
- It is important that all fixings are within the permitted distances as shown below.

## Fixing the sidelight frame.

- First fix the side of the sidelight frame back-to-back with the door frame as shown in the image below.
- Sidelight frames require twin rows of fixings. The rows should be spaced 40mm apart. Fixings are to be a maximum of 50mm from the edge of the frame and a maximum of 250mm centers as shown on page 03.

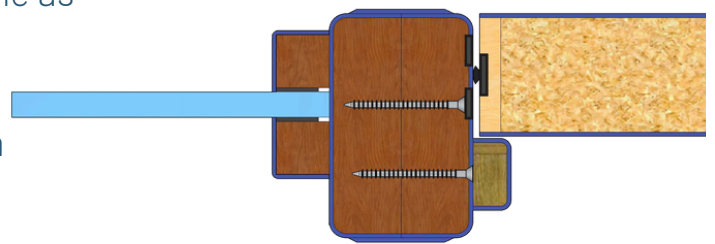

Fixings at 20°  
angle to bead

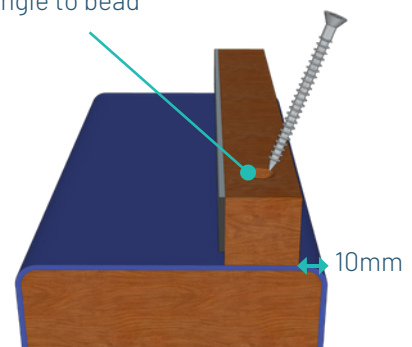

10mm

## Fitting the first set of glazing beads.

- First, measure 10mm in from the edge of the sidelight frame on the side the door will be hung and mark at intervals around the sidelight frame.
- Pre-drill and counter-sink the beading, 50mm from the edge of the beading and 250mm maximum centers.
- Fix the head and the cill beading first to this 10mm offset. Aim for a 20° angle inwards towards the glazing. **DO NOT Allow the fixings to come into contact with any glazing.** The beading for the head and cill are to the full internal width of the sidelight frame as shown in the image below.

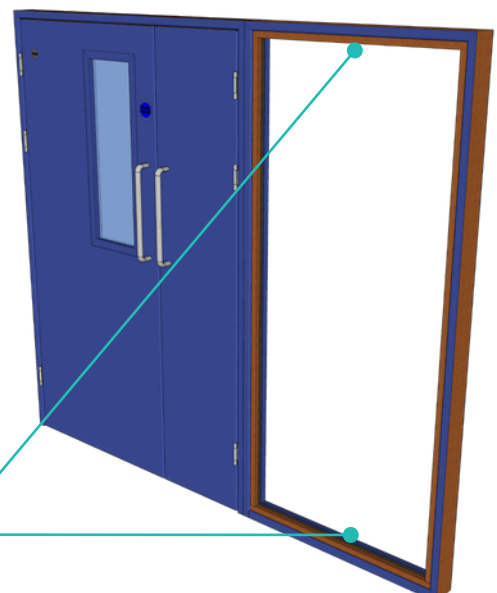

Head and cill beading running full internal  
width of sidelight frame.

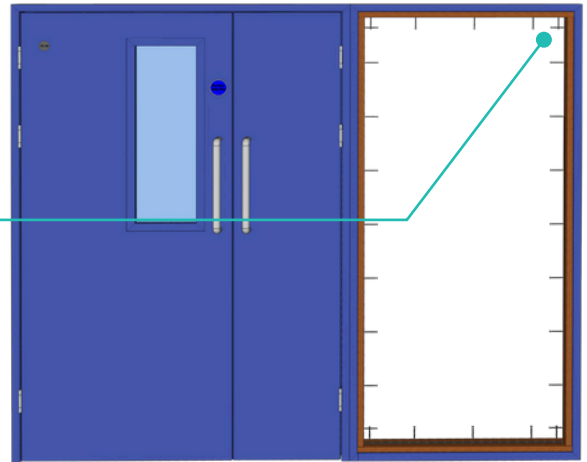
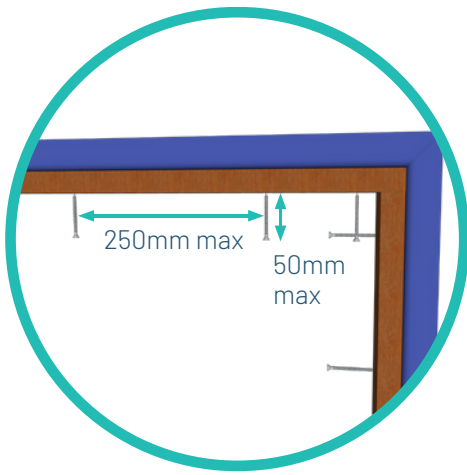

## Fit the PVC cover to the first half of the glazing bead.

- Covers are to be mitred.
- Apply foam tape to the center of one side of the beading.
- Apply a bead of 'PinkGrip' to the internal corner of the PVC cover.
- Fix into place, ensuring no gaps in the covers.

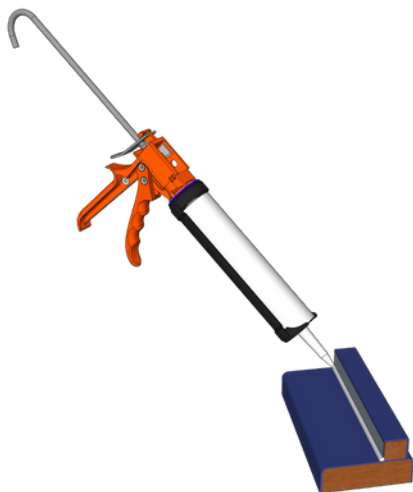
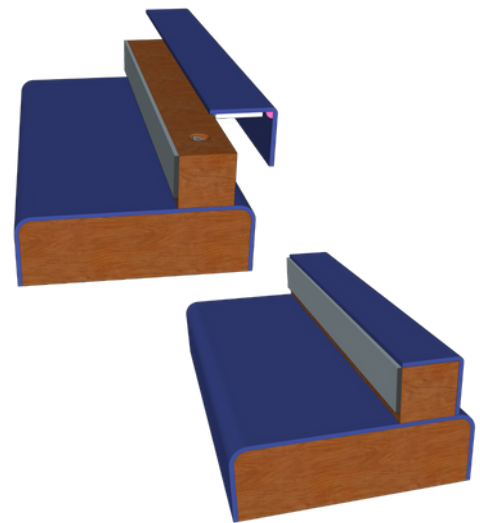

## Fitting the glazing.

- Apply a generous bead of intumescent mastic to the internal corner of the beading as shown in the image opposite.

- Position the glazing into place. It can help to angle the base of the glazing into position.
- It may be of benefit to have your secondary beading pre-cut, pre-drilled and counter-sunk to aid with ease of installing the glazing.



- Align the head and cill of the secondary beading and before fixing, ensure the beading is fully butted up to the face of the glazing, with the intumescent strip in contact with the glazing as shown in the image below.
- Secure in place as before with the same distances between hole centers.

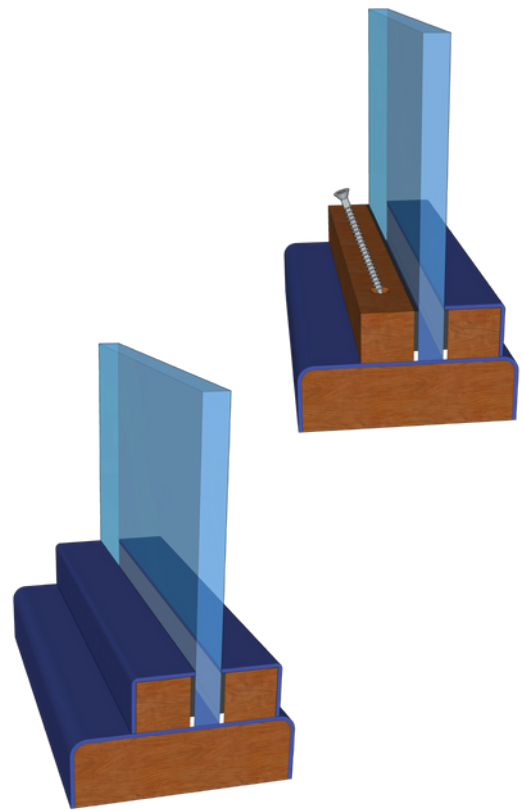

- Apply PVC Cover to secondary beading as before.

## Applying beveled strip and final checks.

- Apply the beveled strip over the reveal between the sidelight frame and door frame.
- Use the supplied double-sided tape.
- Repeat on other side
- Ensure all PVC mitres join up and there are no gaps in the PVC.
- Check that the glazing is fully secured within the beading and frame. There should be no movement.

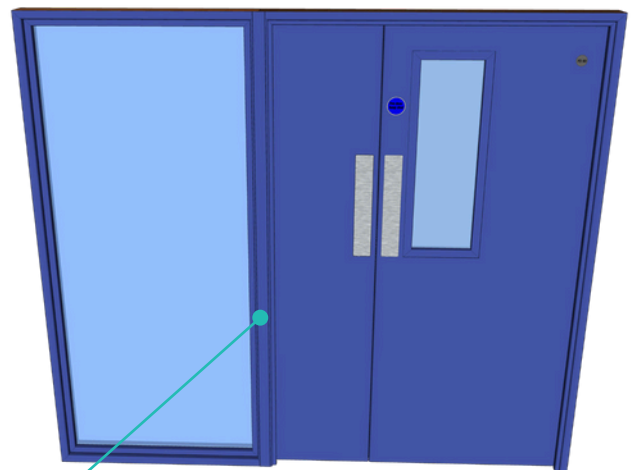

Beveled strip



For further information, contact us:

**T** 01420 543222

**E** [sales@specialistdoorsolutions.com](mailto:sales@specialistdoorsolutions.com)

Unit 1 Bordon Trading Estate, Old Station Way, Bordon, Hampshire GU35 9HH

[specialistdoorsolutions.com](http://specialistdoorsolutions.com)